

# Rigid Folding Wine Boxes



**4-Color Process Print**

Minimum 50 Boxes

**New!**

- Black Matte Anti Scratch finish now in 2-bottle
- Ships flat, easy open & fully collapsible
- Magnetic Closure
- Full length inserts included for BB2

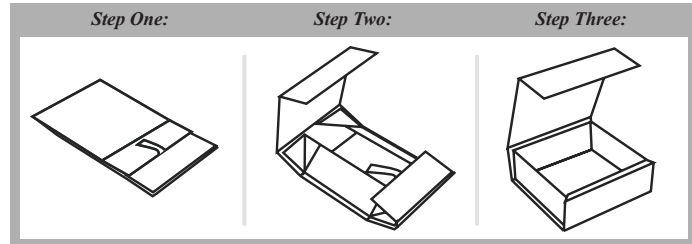

Price per EACH

Product Code	Style	Actual Wt
<b>Process Printed - Rigid Folding Wine Boxes: Matte Black (MBLA) w/ Anti Scratch Finish &amp; White Gloss (GWHI)</b>		
PR-RFBB1___	13-1/2 x 3-1/2 x 3-1/2 (White Gloss Only)	0.8
PR-RFBB2___	13-1/2 x 7 x 3-1/2 w bottle inserts	1.1

## Unprinted Boxes

Product Code	Style	Actual Ship Wt
<b>White Gloss Finish (GWHI)</b>		
RF-XBB1GWHI	13-1/2 x 3-1/2 x 3-1/2	0.8
RF-XBB2GWHI	13-1/2 x 7 x 3-1/2 w bottle inserts	1.1
<b>New! Black Matte (MBLA) with Anti Scratch Finish</b>		
RF-XBB2MBLA	13-1/2 x 7 x 3-1/2 w bottle inserts	1.1

# Wine Carriers & Boxes



**4-Color Process Print**

Minimum 60 Boxes

Price includes  
One Side Printing, Product,  
and ALL Setup Charges!

Product Code	Style	Size	Ctn
<b>Wine Bottle Carriers</b>			
PR-ITBS1___	Sculpted 1 Bottle Carrier	3-1/2 x 3-1/2 x 15	100
PR-ITBC1___	1 Bottle Carrier	3-1/2 x 3-1/2 x 15	50
PR-ITBC2___	2 Bottle Carrier	7 x 3-1/2 x 15	30
PR-ITBC3___	3 Bottle Carrier	10-5/8 x 3-1/2 x 15	30
PR-ITWT4___	4 Bottle Open Style	7 x 7 x 13-3/4	30
PR-ITWT6___	6 Bottle Open Style	10-5/8 x 7 x 13-3/4	30
<b>Wine Bottle Boxes</b>			
PR-ITBBMNER	Magnum 1 Bottle Box	4-1/2 x 4-1/2 x 16-3/4	20
PR-ITBB1___	1 Bottle Box (Side Opening)	3-3/4 x 3-3/4 x 13-3/8	100
PR-ITBBV1TAW	1 Bottle Box (End Opening)	3-1/2 x 3-1/2 x 13-3/8	50
PR-ITBB2___	2 Bottle Box (IT prefix)	7-1/4 x 3-1/2 x 13-3/8	30
PR-LTBB2___	2 Bottle Box (LT prefix)	7-1/8 x 3-1/2 x 13	10
PR-ITBB3___	3 Bottle Box (IT prefix)	11 x 3-1/2 x 13-3/8	30
PR-LTBB3___	3 Bottle Box (LT prefix)	11 x 3-1/2 x 13-3/8	10
PR-LTWB7___	Window 2 Bottle Box	7-7/8 x 13-3/16 x 3-1/2	10
PR-LTWB11___	Window 3 Bottle Box	11-3/8 x 13-1/8 x 3-1/2	10

Price per EACH

Price above includes one side printing, product and ALL set up charges.

Must be ordered in full cases.

Production Time: 7-10 business days from proof approval

Subject to review of artwork and pricing if print area exceeds 75% of print surface.

Exact PMS colors are not possible as all colors are converted to CMYK. Reference a Pantone PMS color bridge to see how your PMS color will appear. Prices subject to review of art. Additional charges may apply to orders with excess ink coverage.

© Identifies products manufactured in China that have recently been affected by a tariff. The tariffs are included in these prices.